



WATERCO
EUROPE LTD
water, the liquid of life

micron fibreglass filters

micron fibreglass filters



micron fibreglass filters: proven strength and durability

Micron filters operate on the basis of “depth filtration”; dirt is driven through the filter bed and trapped in minute spaces between the particles of filter media allowing the cleansed water to pass through the filter’s laterals and exit via the filter’s multiport valve.

simple maintenance

The effectiveness and efficiency of the filter is impaired by excessive build up of debris, clogging the media, which will result in pressure build up and poor circulation. Cleaning the filter simply requires turning the filter’s multiport lever from the “filter” position to the “backwash” position, which reverses the flow of water in the filter, flushing the filter bed.

filament wound filters

Micron fibreglass filters embody the latest in fibreglass winding technology. Micron fibreglass vessels consist of an inner shell of fibreglass reinforced polyester resin wound over with fibreglass filament. Waterco’s digitally controlled filament winding machine faultlessly winds continuous strands of high quality fibreglass filament under controlled tension filament to create a seamless one-piece vessel with refined consistency and superior quality. There are no welds or seams or special tank linings which can corrode or electrolyse.

warranty

Micron filters are covered by a 10 year tank warranty and 1 year warranty on all other components. Commercial installations are covered by a 5 year (1 year full + 4 years pro rata) tank warranty and 1 year warranty on all other components. Please refer to Waterco’s warranty terms and conditions.

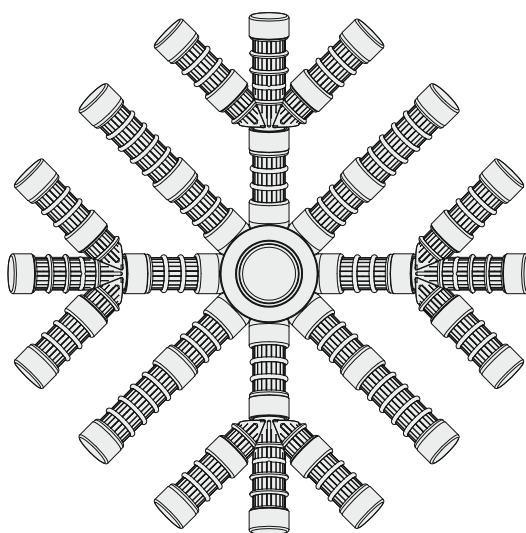

fishtail laterals

In a conventional lateral system “Dead legs” exist between the laterals and water flow is not optimised through the filter bed. Waterco’s “Fish Tail” lateral configuration eliminates any “dead legs” by improving water flow distribution through the filter bed.

The fishtail lateral design significantly improves filtration and reduces backwash times ultimately saving water.

This system is now standard on the Micron range.

top mount configuration – filter mode

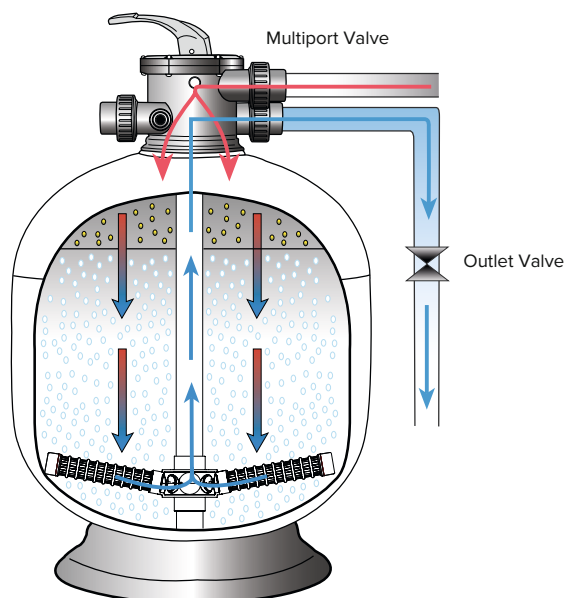

side mount configuration – filter mode

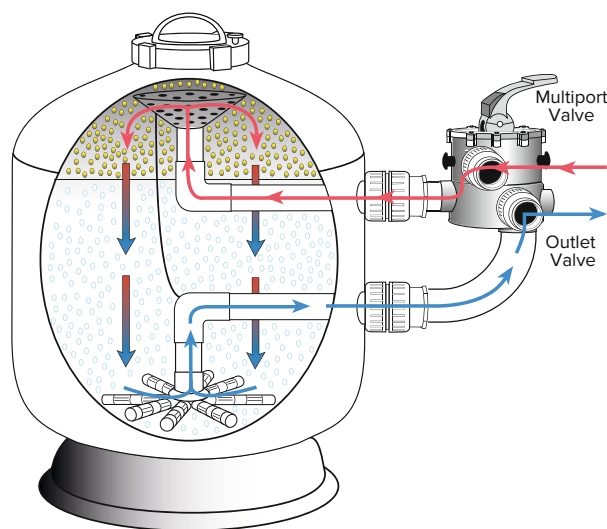

micron fibreglass filters

waterco micron top and side mount fibreglass filters features

micron top mount filters *optional manual drain



side mount fibreglass filters



- 1 Inflow diffuser for even distribution of water flow across the filter bed.
 - 2 Pressure gauge.
 - 3 Six position multiport valve with sight glass and quick connect half unions.
 - 4 Fibreglass wound tank, UV and corrosion resistant.
 - 5 Hydraulically balanced laterals to maximise water flow and filtration.
 - 6 Manual drain*.
 - 7 Large filter base for stable floor mounting.
- Working pressure 250 kPa (36 psi).
 - Extra reinforcement to increase the working pressure rating to 400 kPa (58 psi) is available on request.
 - Maximum working temperature of 50 °C (122 °F).

waterco multiport valves

Constructed from heavy duty ABS, Waterco multiport valves are designed for maximum performance and working pressures. Waterco multiport valves are engineered to withstand a working pressure of up to 400kPa (58 psi) with a test pressure of 600kPa (87 psi).

- 1 Metric or imperial quick connect unions.
- 2 Glass filled thermoplastic.
- 3 Durable lever action handle.
- 4 6 way multiple valve positions.
- 5 High grade stainless steel components.
- 6 Pressure gauge.
- 7 Wear resistant rotor.
- 8 Clear sight glass for backwash inspection.

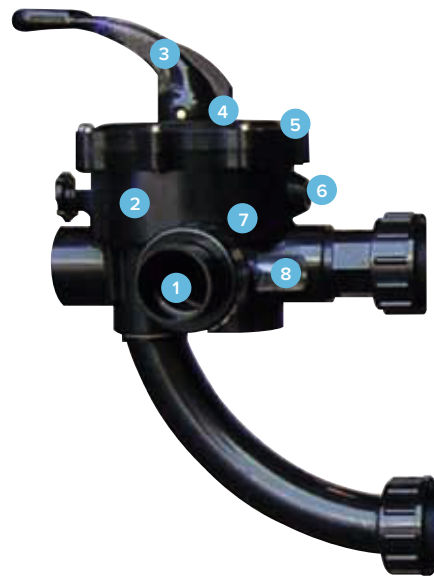

micron fibreglass filters

micron top mount filter technical specifications

Code	Filter Model	Valve Size	Inner Diameter	Filter Area	Bed Depth	Domestic Flow Rate	Maximum Pool Size	Commercial Flow Rate	Minimum Pool Size	Sand	Glass
15 97 254 350	S500	50mm/1½"	500mm	0.20m ²	280mm	10m ³ /hr	57m ³	7.2m ³ /hr	28m ³	80kg	60kg
15 97 254 370	S702	63mm/2"	700mm	0.40m ²	340mm	19m ³ /hr	115m ³	14.4m ³ /hr	56m ³	200kg	151kg
15 97 254 375	S750	63mm/2"	750mm	0.46m ²	340mm	22m ³ /hr	132m ³	16.5m ³ /hr	64m ³	220kg	166kg

micron top mount filter dimensions

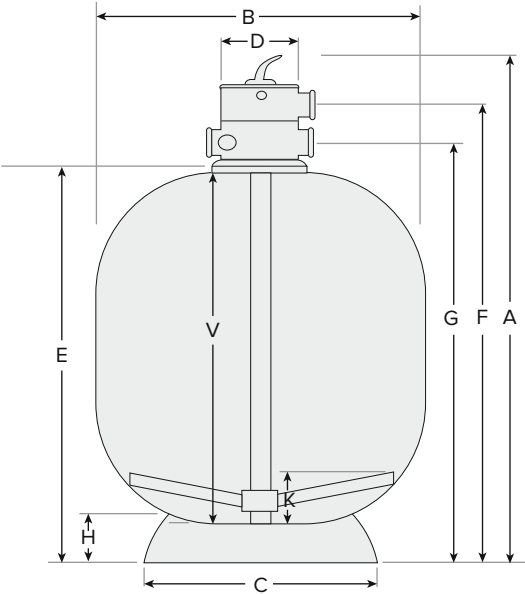

Code	Model	A	B	C	D	E	F	G	H	V	K
15 97 254 350	S500	864mm	505mm	443mm	180mm	625mm	731mm	672mm	69mm	525mm	94mm
15 97 254 370	S702	1072mm	723mm	620mm	220mm	722mm	892mm	792mm	90mm	652mm	122mm
15 97 254 375	S750	1217mm	772mm	620mm	220mm	867mm	1037mm	937mm	90mm	773mm	127mm

Residential flow rate based on a velocity of 48 m³/hr/m². Max. pool size is based on a 6 hr turnover.

micron side mount filter technical specifications

Code	Filter Model	Valve Size	Inner Diameter	Filter Area	Bed Depth	Domestic Flow	Maximum Pool Size	Commercial Flow	Minimum Pool Size	Sand	Glass
15 52 253 350	SM500	50 mm/1½"	500mm	0.20 m ²	290mm	10 m ³ /hr	56 m ³	7 m ³ /hr	43.2 m ³	90 kg	74 kg
15 52 253 360	SM600	50 mm/1½"	600mm	0.28 m ²	360mm	14 m ³ /hr	81 m ³	10 m ³ /hr	60.5 m ³	140 kg	115 kg
15 52 253 370	SM700	63 mm/2"	700mm	0.38 m ²	380mm	19 m ³ /hr	111 m ³	14 m ³ /hr	82.1 m ³	190 kg	156 kg
15 52 253 375	SM750	63 mm/2"	750mm	0.44 m ²	400mm	21 m ³ /hr	127 m ³	16 m ³ /hr	95.0 m ³	210 kg	173 kg
15 52 253 390	SM900	63 mm/2"	900mm	0.64 m ²	400mm	31 m ³ /hr	183 m ³	23 m ³ /hr	138.2 m ³	360 kg	296 kg

micron side mount filter dimensions

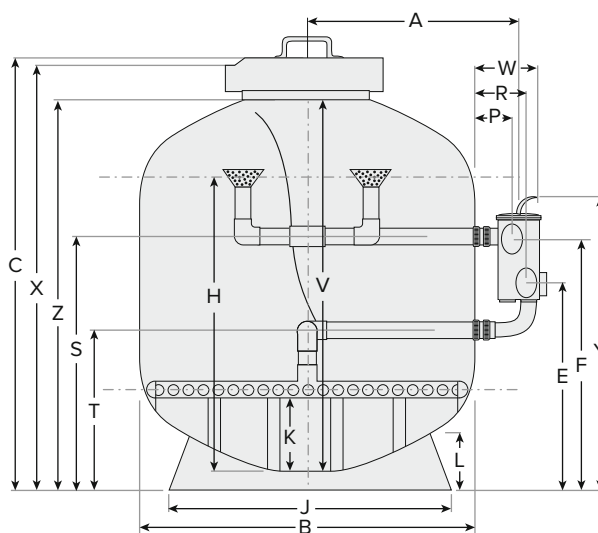

Code	Model	A	B	C	W	R	P	E	F	K
15 52 253 350	SM500	464mm	520mm	815mm	310mm	215mm	153mm	594mm	649mm	100mm
15 52 253 360	SM600	518mm	622mm	880mm	310mm	215mm	153mm	629mm	680mm	105mm
15 52 250 370	SM700	565mm	719mm	948mm	321mm	248mm	178mm	520mm	601mm	120mm
15 52 253 375	SM750	587mm	772mm	993mm	321mm	248mm	178mm	593mm	674mm	113mm
15 52 253 390	SM900	667mm	923mm	1115mm	321mm	248mm	178mm	656mm	737mm	113mm

Code	Model	V	H	L	X	Y	Z	J	S	T
15 52 253 350	SM500	652mm	585mm	70mm	743mm	790mm	715mm	445mm	485mm	282mm
15 52 253 360	SM600	680mm	601mm	88mm	804mm	825mm	778mm	540mm	520mm	317mm
15 52 250 370	SM700	728mm	685mm	90mm	905mm	750mm	835mm	620mm	520mm	317mm
15 52 253 375	SM750	763mm	652mm	120mm	914mm	823mm	892mm	678mm	593mm	390mm
15 52 253 390	SM900	860mm	750mm	120mm	1030mm	886mm	1011mm	678mm	656mm	453mm

micron commercial fibreglass filters

designed and built for high performance and reliability

Manufactured from the highest grade of non-corrosive materials and employing the latest in fibreglass winding technology, Micron fibreglass filters are designed and built for many years of trouble free operation. Micron commercial fibreglass filters are available in top mount, side mount and horizontal configurations with filter areas of 0.87 m² to 10.0 m².

waterco fibreglass wound filters

Waterco fibreglass filters embody the latest in fibreglass winding technology. Waterco fibreglass vessels consist of an inner shell of fibreglass reinforced polyester resin over wound with fibreglass filament.

Waterco's digitally controlled filament winding machine faultlessly winds continuous strands of fibreglass filament to create a filter vessel with refined consistency and superior quality.

waterco "fishtail" laterals

Conventional laterals are not suitable for larger sized commercial filters. "Dead legs" exist between the laterals and water flow is not optimised through the filter bed. Waterco's "fishtail" lateral configuration eliminates any "dead legs" by improving water flow distribution through the filter bed.

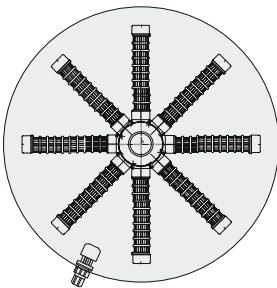

Conventional lateral configuration

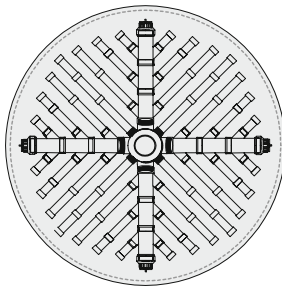

All filters up to those with 2½"/65mm ports

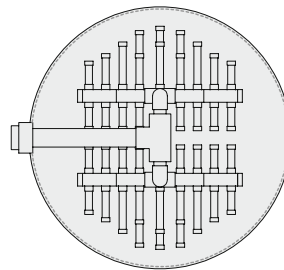

Commercial vertical filters with 3"/80mm ports

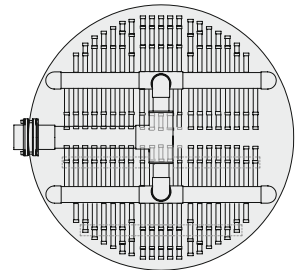

Commercial vertical filters with 4"/100mm, 6"/150mm, 8"/200mm ports

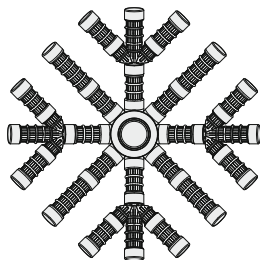

Fishtail laterals

waterco micron side mount fibreglass filters features



- 1 Inflow diffuser for even distribution of water flow across the filter bed.
 - 2 Man hole access.
 - 3 Pressure gauge.
 - 4 Six position multiport valve with sight glass and quick connect half unions.
 - 5 Fibreglass wound tank, UV and corrosion resistant.
 - 6 Manual drain.
 - 7 Hydraulically balanced laterals to maximise water flow and filtration.
 - 8 Large filter base for stable floor mounting.
- Maximum working temperature of 50°C (122°F).
 - Pressure rated at 2.5 Bar/250 kPa/36 psi, 4 Bar/400 kPa/58 psi, 6 Bar/600 kPa/87 psi and up to 8 Bar/800 kPa/116 psi.
 - Optional fibreglass reinforced vinyl ester vessels for ozone applications are available on request.

smd & smdd filters



smd and smdd micron side mount deep bed filters

The effect of deep media bed improves the filtration efficiency over standard high-rate filters by providing enhanced in-depth filtration and increased dirt capacity. In addition, the greater bed depth permits efficient use of mixed bed filter media and water treatment media such as granular activated carbon.

The filter's 1000mm (SMD) to 1200mm (SMDD) media bed ensures that finer dirt particles and colloidal substances are retained to a far greater level than a filter with a shallower bed depth.

micron smd filter technical specifications

Code	Filter Model	Valve Size	Bed Depth	Inner Diameter	Filter Area	Filtration Flow Rates 30m³/hr/m²	Backwash Flow Rates 40m³/hr/m²	Sand	Glass
15 97 259 105	SMD1050	90mm/3"	1000mm	1050mm	0.87m²	26m³/hr	35m³/hr	1410kg	1159kg
15 97 259 120	SMD1200	90mm/3"	1000mm	1200mm	1.13m²	34m³/hr	45m³/hr	1720kg	1414kg
15 97 259 140	SMD1400	90mm/3"	1000mm	1400mm	1.54m²	46m³/hr	62m³/hr	2515kg	2067kg
15 97 259 160	SMD1600	90mm/3"	1000mm	1600mm	2.01m²	60m³/hr	80m³/hr	3170kg	2605kg
15 97 259 180	SMD1800	110mm/4"	1000mm	1800mm	2.54m²	76m³/hr	102m³/hr	4205kg	3456kg

*Waterco's recommended flow rates per port size:

3"/90mm: 64.8m³/hr, 4"/110mm: 108m³/hr

micron smd filter dimensions

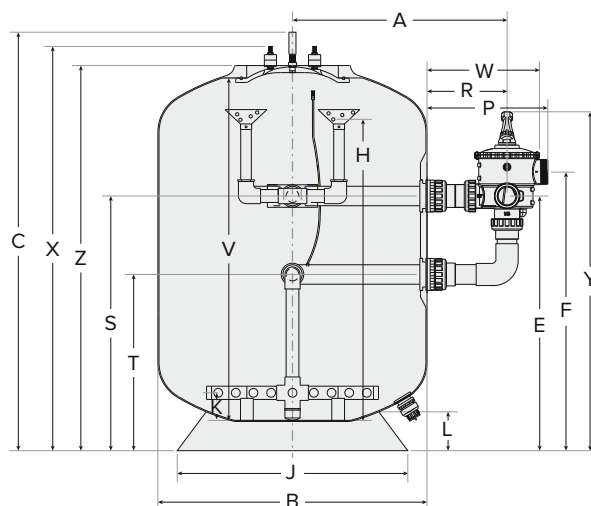

Code	Model	A	B	C	W	R	P	E	F	K
15 97 259 105	SMD1050	901mm	1077mm	1890mm	510mm	363mm	548mm	1100mm	1210mm	176mm
15 97 259 120	SMD1200	977mm	1229mm	1905mm	510mm	363mm	548mm	1154mm	1264mm	176mm
15 97 259 140	SMD1400	1083mm	1442mm	1955mm	510mm	363mm	548mm	1204mm	1314mm	218mm
15 97 259 160	SMD1600	1184mm	1644mm	1994mm	510mm	363mm	548mm	1151mm	1261mm	218mm
15 97 259 180	SMD1800	1863mm	1839mm	1985mm	943mm	474mm	629mm	751mm	413mm	315mm

Code	Model	V	H	L	X	Y	Z	J	S	T
15 97 259 105	SMD1050	1587mm	1470mm	176mm	1805mm	1482mm	1735mm	1045mm	1100mm	744mm
15 97 259 120	SMD1200	1568mm	1400mm	176mm	1820mm	1536mm	1750mm	1045mm	1154mm	798mm
15 97 259 140	SMD1400	1615mm	1500mm	218mm	1870mm	1586mm	1800mm	1202mm	1204mm	848mm
15 97 259 160	SMD1600	1615mm	1500mm	218mm	1909mm	1533mm	1839mm	1202mm	1151mm	795mm
15 97 259 180	SMD1800	1660mm	1550mm	315mm	1900mm	751mm	1830mm	1755mm	1183mm	751mm

micron smdd filter technical specifications

Code	Filter Model	Valve Size	Bed Depth	Inner Diameter	Filter Area	Filtration Flow Rates 30m ³ /hr/m ²	Backwash Flow Rates 40m ³ /hr/m ²	Sand	Glass
15 97 260 075	SMDD750	63mm/2"	1200mm	750mm	0.44 m ²	13 m ³ /hr	18 m ³ /hr	1410 kg	653 kg
15 97 260 090	SMDD900	90mm/3"	1200mm	900mm	0.64 m ²	19 m ³ /hr	25 m ³ /hr	1200 kg	986 kg
15 97 260 105	SMDD1050	90mm/3"	1200mm	1050mm	0.87 m ²	26 m ³ /hr	35 m ³ /hr	1665 kg	1386 kg
15 97 260 120	SMDD1200	90mm/3"	1200mm	1200mm	1.13 m ²	34 m ³ /hr	45 m ³ /hr	2045 kg	1681 kg
15 97 260 140	SMDD1400	110mm/4"	1200mm	1400mm	1.54 m ²	46 m ³ /hr	62 m ³ /hr	2840 kg	2334 kg
15 97 260 160	SMDD1600	110mm/4"	1200mm	1600mm	2.01 m ²	60 m ³ /hr	80 m ³ /hr	3685 kg	3029 kg
15 97 260 180	SMDD1800	160mm/6"	1200mm	1800mm	2.54 m ²	76 m ³ /hr	102 m ³ /hr	4975 kg	4089 kg

*Waterco's recommended flow rates per port size:

2"/63mm: 30.6m³/hr, 3"/90mm: 64.8m³/hr,
4"/110mm: 108m³/hr, 6"/160mm: 205.2m³/hr

micron smdd filter dimensions

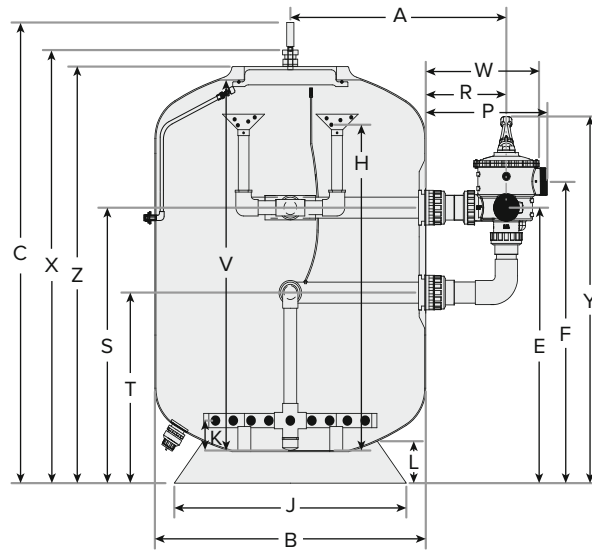

Code	Model	A	B	C	W	R	P	E	F	K
15 97 260 075	SMDD750	613mm	772mm	2044mm	334mm	262mm	191mm	1586mm	1688mm	120mm
15 97 260 090	SMDD900	824mm	923mm	2268mm	510mm	363mm	548mm	1680mm	1790mm	155mm
15 97 260 105	SMDD1050	901mm	1077mm	2270mm	510mm	363mm	548mm	1650mm	1760mm	176mm
15 97 260 120	SMDD1200	977mm	1229mm	2243mm	510mm	363mm	548mm	1665mm	1775mm	176mm
15 97 260 140	SMDD1400	1205mm	1442mm	2313mm	689mm	556mm	440mm	1330mm	1465mm	218mm
15 97 260 160	SMDD1600	1306mm	1644mm	2285mm	689mm	474mm	629mm	989mm	651mm	218mm
15 97 260 180	SMDD1800	n/a	1839mm	2260mm	n/a	n/a	n/a	n/a	n/a	315mm

Code	Model	V	H	L	X	Y	Z	J	S	T
15 97 260 075	SMDD750	1780mm	1713mm	120mm	2011mm	1845mm	1938mm	678mm	1586mm	1383mm
15 97 260 090	SMDD900	1930mm	1780mm	120mm	2183mm	2062mm	2113mm	678mm	1680mm	1324mm
15 97 260 105	SMDD1050	1950mm	1820mm	176mm	2185mm	2032mm	2115mm	1045mm	1650mm	1294mm
15 97 260 120	SMDD1200	1900mm	1750mm	176mm	2158mm	2047mm	2088mm	1045mm	1665mm	1309mm
15 97 260 140	SMDD1400	1975mm	1800mm	218mm	2228mm	1774mm	2158mm	1202mm	1330mm	898mm
15 97 260 160	SMDD1600	1950mm	1800mm	218mm	2200mm	1865mm	2130mm	1202mm	1421mm	989mm
15 97 260 180	SMDD1800	2010mm	1920mm	315mm	2175mm	n/a	2105mm	1755mm	1383mm	900mm

micron spdd nozzle plate filters



micron spdd nozzle plate filters

Micron SPDD filters are fitted with a plate and nozzle system, which ensures uniform flow for both filtering and backwashing, ensuring maximum performance through the media bed.

The nozzle plate system also allows the introduction of pressurised air directly into the bottom of the filter media. Uniform introduction of air and water through the nozzle plate provides vigorous agitation and filter media bed expansion required for an effective air/water backwash leading to reduced backwashing times and reduced volumes of water. Save up to 25% of backwash water.

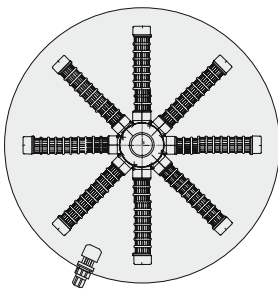

Conventional lateral configuration

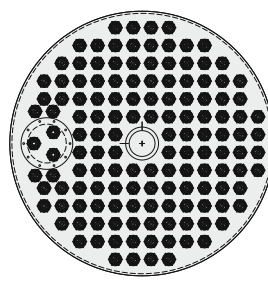

Nozzle plate configuration

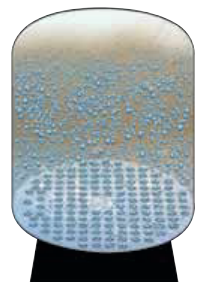

micron spdd filter technical specifications

Code	Filter Model	Flange Size	Bed Depth	Inner Diameter	Filter Area	Filtration Flow Rates 30m³/hr/m²	Backwash Flow Rates 40m³/hr/m²	Sand	Glass
15 97 261 105	SPDD1050	90mm/3"	1200mm	1050mm	0.87m²	26m³/hr	35m³/hr	1485kg	1221kg
15 97 261 120	SPDD1200	90mm/3"	1200mm	1200mm	1.13m²	34m³/hr	45m³/hr	1930kg	2170kg
15 97 261 140	SPDD1400	110mm/4"	1200mm	1400mm	1.54m²	46m³/hr	62m³/hr	2640kg	2170kg
15 97 261 160	SPDD1600	110mm/4"	1200mm	1600mm	2.01m²	60m³/hr	80m³/hr	3455kg	2840kg
15 97 261 180	SPDD1800	160mm/6"	1200mm	1800mm	2.54m²	76m³/hr	102m³/hr	4330kg	3559kg
15 97 261 200	SPDD2000	160mm/6"	1200mm	2000mm	3.14m²	94m³/hr	126m³/hr	5360kg	4405kg
15 97 261 235	SPDD2350	160mm/6"	1200mm	2350mm	4.34m²	130m³/hr	174m³/hr	7430kg	6107kg

Waterco's recommended flow rates per port size:

3"/90mm: 64.8m³/hr, 4"/110mm: 108m³/hr,

6"/160mm: 205.2m³/hr

micron spdd filter dimensions

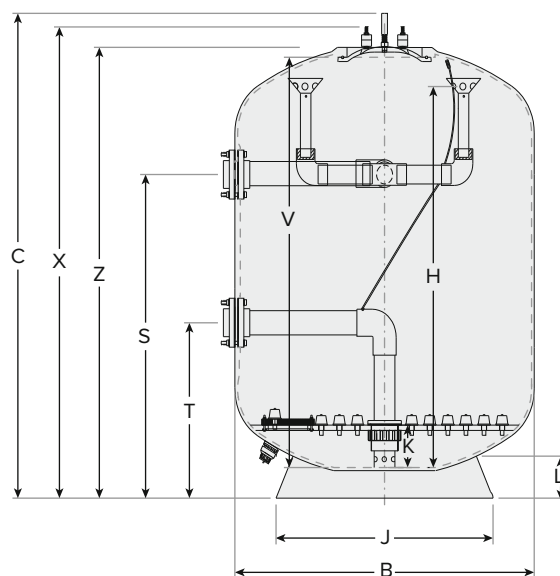

Code	Model	B	C	K	V	H	L
15 97 261 105	SPDD1050	1077mm	2270mm	220mm	1950mm	1820mm	176mm
15 97 261 120	SPDD1200	1229mm	2243mm	150mm	1900mm	1750mm	176mm
15 97 261 140	SPDD1400	1442mm	2313mm	200mm	1975mm	1800mm	218mm
15 97 261 160	SPDD1600	1644mm	2285mm	200mm	1950mm	1800mm	218mm
15 97 261 180	SPDD1800	1839mm	2260mm	320mm	2010mm	1920mm	315mm
15 97 261 200	SPDD2000	2042mm	2398mm	320mm	2100mm	1920mm	245mm
15 97 261 235	SPDD2350	2390mm	2435mm	355mm	2118mm	1955mm	340mm

Code	Model	X	Z	J	S	T
15 97 261 105	SPDD1050	2185mm	2115mm	1045mm	1450mm	750mm
15 97 261 120	SPDD1200	2158mm	2088mm	1045mm	1449mm	749mm
15 97 261 140	SPDD1400	2228mm	2158mm	1202mm	1514mm	814mm
15 97 261 160	SPDD1600	2200mm	2130mm	1202mm	1529mm	829mm
15 97 261 180	SPDD1800	2175mm	2105mm	1755mm	1489mm	789mm
15 97 261 200	SPDD2000	2313mm	2243mm	1755mm	1489mm	789mm
15 97 261 235	SPDD2350	2330mm	2330mm	2037mm	1550mm	950mm

